

zencontrol

Scenepanel datasheet



Features

- 15 mA DALI line current
- Multiple finishes available
- Up to 10 units per DALI line
- Accessories for 1 - 4 buttons per plate
- Models to suit 64 and 80 mm mounting centres
- Customisable labels available for specific applications
- Selectable button additions on DALI application controller



Powered by DALI

No additional supply means energy savings and simple installation



DALI-2

For use with DALI-2 compliant application controller



Integrated illumination

Configurable inbuilt LED status indicator for user convenience



Configurable

Various button layouts to suit application

zencontrol

Scenepanel datasheet



Product range

Order code	Description
zc-scene-a4	Standard Scenepanel to suit 60 mm wall mount
zc-scene-c-a4	C-clip compatible Scenepanel to suit 84 mm wall mount

Features

- 15 mA DALI line current
- Multiple finishes available
- Up to 10 units per DALI line
- Multiple control devices per line
- Accessories for 1 - 4 buttons per plate
- Designed for compliance to IEC 62386-301*
- Customisable labels available for specific projects
- For use with DALI-2 compliant application controller
- Control scenes / groups / actions / events with a zencontrol control system

* Pending publication of test sequences

Dimensions

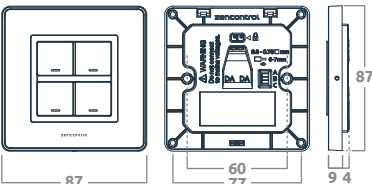

zc-scene-a4
Dimensions 87 / 87 / 13 mm
Mounting centres 64 mm

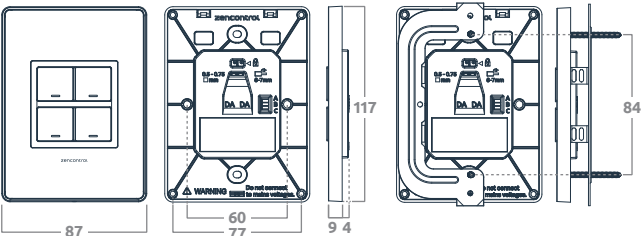

zc-scene-c-a4
Dimensions 87 / 117 / 13 mm
Mounting centres 80 mm

Common configurations

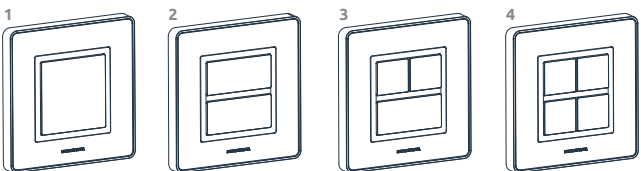

Specifications

Supply	DALI
Control system	DALI-2
DALI line current	15 mA
Wiring	0.5 - 0.75 mm ² Strip 6 - 7 mm
Operating temperature	0 to 45°C
Material	PC UV stabilised, ABS, 316 stainless
Ingress protection	IP20
Compliance standards	IEC 61347-2-11 CISPR 15 IEC 62386-301 EMC-2004/108/EC LVD-2006/95/EC

Notice

- The switch must not be connected to any mains. It is powered directly from the DALI line.
- The DALI line is not SELV. It must be treated like LV mains and treated with the same precautions and wiring regulations.
- Compatible with zencontrol control system with a firmware version of 00.08.10 or above

Kit content

zc-scene-a4	
zc-scene-btn-2	2 x blank half button
zc-scene-btn-4	2 x blank quarter button
zc-scene-frm-mult	2 - 4 button frame
zc-scene-fp-st	Brushed stainless faceplate
**Not included	C-clip

Accessory range

Order code	Description
zc-scene-btn-1	Blank single button (note requires zc-scene-frm-s/-c)
zc-scene-btn-2	Blank half button
zc-scene-btn-4	Blank quarter button
zc-scene-frm-s	Single button frame to suit square base
zc-scene-frm-mult	2 - 4 button frame to suit square base
zc-scene-frm-c	Single button frame to suit c-clip base
zc-scene-frm-mult-c	2 - 4 button frame to suit c-clip base
zc-scene-fp-st	Brushed stainless faceplate for standard model
zc-scene-fp-st-c	Brushed stainless faceplate for c-clip model